

SHEPHERD TIDE



HART TIDE as shown, SHEPHERD TIDE similar

MMC 887 PLATFORM SUPPLY VESSEL

Vessel Characteristics

Length, Overall:	285.8 ft	87.1 m
Beam:	61.7 ft	18.8 m
Depth:	24.3 ft	7.4 m
Maximum Draft:	20 ft	6.1 m
Light Draft:	7.6 ft	2.3 m
Minimum Height:	91.2 ft	27.8 m
Freeboard:	4.6 ft	1.4 m
Displacement:	7,600 lt	7,720 mt
Deadweight:	5,070 lt	5,150 mt
Clear Deck Space:	196 x 52 ft	60 x 16 m
Clear Deck Area:	9,980 ft ²	930 m ²
Deck Strength AFT:	1,020 lb/ft ²	5 t/m ²
Class Notations:	ABS: +A1,(E), +AMS, +DPS-2, FFV-1, OSV,UWILD	

Capacities

Deck Cargo:	2,800 lt	2,840 t
Fuel Oil:	240,000 gal	910 m ³
Potable Water:	44,300 gal	170 m ³
Fresh Water:	530,000 gal	2,010 m ³
Drill/Ballast Water:	86,700 gal	330 m ³
Bulk Tanks (5 tanks):	14,700 ft ³	420 m ³
Liquid Mud (2.4 SG*):	15,200 bbl	2,410 m ³
<small>*Max Structural Specific Gravity</small>		
Methanol:	2,700 bbl	430 m ³

TIDEWATER

Find out more

tdw.com

Pg.2 Further Specifications

Pg.4 Capacity Table

Pg.3 General Arrangement

Pg.5 DP Capability Plot



Machinery

Diesel Electric Vessel			
<i>Propulsive/Total HP:</i>	5,360 / 10,200		
Z-Drives:	Yes		
Propellers (2):	4-Blade FP Rolls-Royce		
Kort Nozzles:	2		
Primary Generators (4):	1,820 kw	480 v	60 hz
<i>Driven by:</i>	Cummins QSK60-D(M)		
Emergency Generators (1):	150 kw	480 v	60 hz
<i>Driven by:</i>	Cummins 6CTA8.3-D(M)		
Bow Thruster (2):	1220 HP CPP TT, 1073 HP CPP DD		
<i>Driven by:</i>	ELECTRIC MOTOR DRIVEN		
Total Thrust:	28.7 st	26 mt	

Deck Equipment

Anchors (2):	5456 lbs HHP
Anchor Chain:	250 m of 50 mm chain per side
Windlass:	Electric, 65/32 kn @10/20 m/m
Crane (1):	2 t @ 10.1 m
Capstans (2):	7.5 t Electric, 328 ft. of .5 in.
Tugger (2):	10 t ELECTRIC, PLIMSOLL

Accommodations

No. of Berths:	60
Cabins:	8x1-man, 18x2-man & 4x4-man
Certified to Carry:	60
Galley seating:	30
Hospital:	Yes

Registration

Flag: VANUATU	Home Port: PORT VILA
Hull Number: 6191	IMO N^o: 9533555
Year Built: 2011	Call Sign: YJQM9
Builder:	FUJIAN MAWEI
Tonnage (ITC):	3601 GT 1429 NT

Performance*

Fuel Consumption Vs Speed		
<i>Maximum:</i>	28 m ³ /day (310 gph) @ 14 knots	
<i>Cruising:</i>	12.5 m ³ /day (140 gph) @ 10 knots	
<i>Economical:</i>	10 m ³ /day (110 gph) @ 8 knots	
<i>Standby:</i>	2.3 m ³ /day (25 gph) @ 0 knots	
Range @ 10 Knots:	17,400 nm	
Transfer Rates		
<i>Fuel Oil:</i>	660 gpm @ 300 ft	150 m ³ /h @ 92 m
<i>Fresh Water:</i>	660 gpm @ 300 ft	150 m ³ /h @ 92 m
<i>Drill/Ballast Water:</i>	660 gpm @ 300 ft	150 m ³ /h @ 92 m
<i>Bulk:</i>	49 cfm @ 180 ft	83.2 m ³ /h @ 56 m
<i>Liquid Mud:</i>	660 gpm @ 190 ft	150 m ³ /h @ 58 m
<i>Methanol:</i>	330 gpm @ 300 ft	75 m ³ /h @ 92 m

Nav/Comms Equipment

Radar(s):	2
Depth Sounder:	1
Gyro Compass:	3
Wind Speed Indicators:	3
Doppler Log:	1
Radio:	3 x VHF; 1 x SSB

Special Equipment

Firefighting:	FiFi-1
Dynamic Positioning:	DP-2
Ref. Systems:	2 x MRU; 2 x DGPS 1 x Microwave-based
Water Maker:	2 X 20T/DAY
Mud Circulation System:	Yes
Tank Cleaning:	Yes
Rescue Boat:	Solas Approved
Fuel Monitoring:	FUELTRAX
Reefer Sockets:	4x 480V 32A
Misc:	SEWAGE TREATMENT - 60 Persons

*Approximate values assuming Ideal Conditions

SHEPHERD TIDE

General Arrangement (Current configuration may vary.)

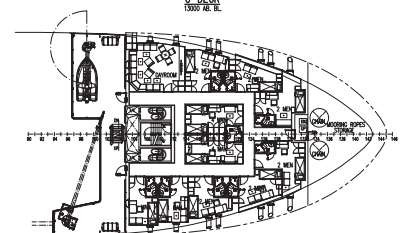
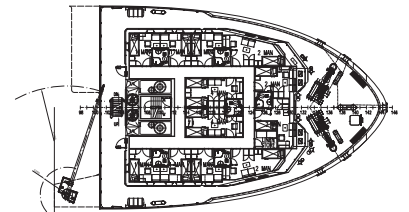
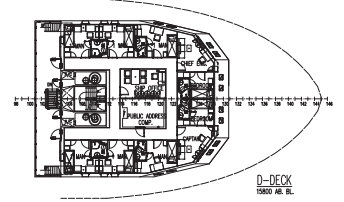
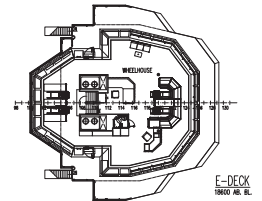
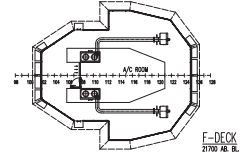
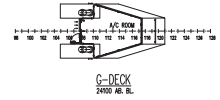
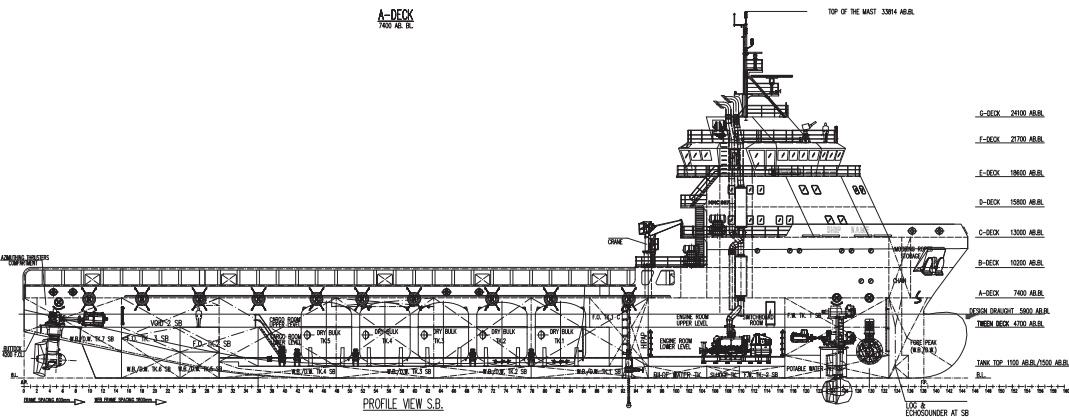
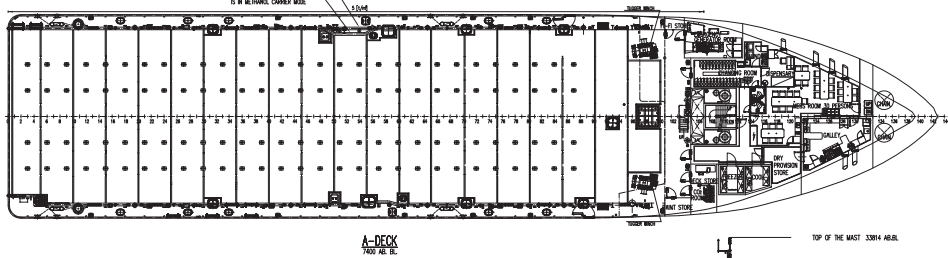
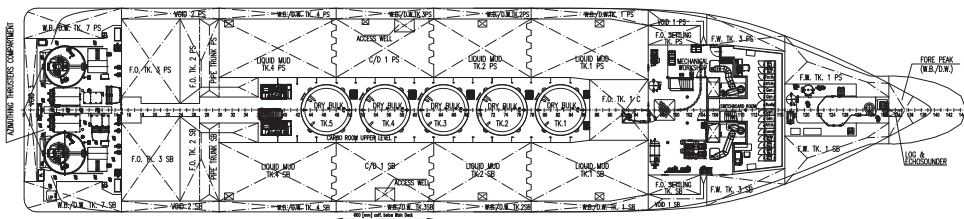
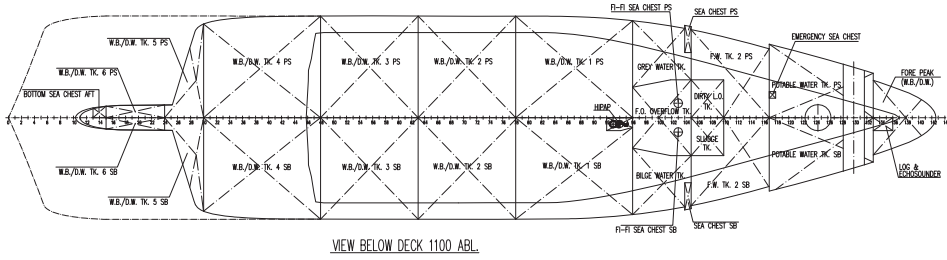
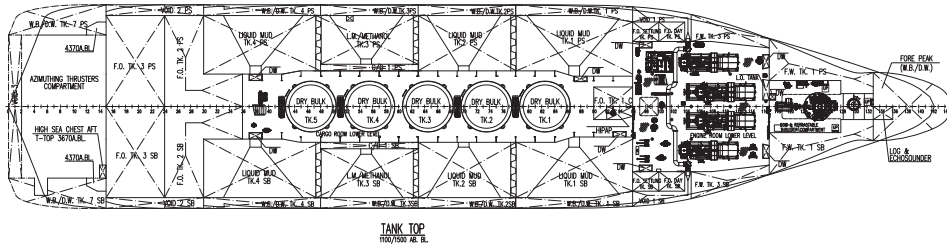

- C-DECK 2400 ABL.
- F-DECK 2100 ABL.
- E-DECK 1800 ABL.
- D-DECK 1500 ABL.
- C-DECK 1300 ABL.
- B-DECK 10200 ABL.
- A-DECK 7400 ABL.
- DECK BRIDGE 5800 ABL.
- THIRTEEN DECK 1000 ABL.
- TANK TOP 1100 ABL/1500 ABL.



Tank Table														
Tank	Contents	Volume m ³	Base Oil	Fuel Oil	Dry Bulk	DW/WB	Potable Water	Fresh Water	Brine	Liquid Mud	Methanol	Lube Oil	Foam	Oil Disp.
Fore Peak	DW/WB	184.0				184.0								
WB/DW Tk 1 PS	DW/WB	184.0				184.0		184.0						
WB/DW Tk 1 SB	DW/WB	180.9				180.9		180.9						
WB/DW Tk 2 PS	DW/WB	152.5				152.5		152.5						
WB/DW Tk 2 SB	DW/WB	152.5				152.5		152.5						
WB/DW Tk 3 PS	DW/WB	150.9				150.9		150.9						
WB/DW Tk 3 SB	DW/WB	150.9				150.9		150.9						
WB/DW Tk 4 PS	DW/WB	165.9				165.9		165.9						
WB/DW Tk 4 SB	DW/WB	165.9				165.9		165.9						
WB/DW Tk 5 PS	DW/WB	42.4				42.4		42.4						
WB/DW Tk 5 SB	DW/WB	42.4				42.4		42.4						
WB/DW Tk 6 PS	DW/WB	57.8				57.8		57.8						
WB/DW Tk 6 SB	DW/WB	57.8				57.8		57.8						
WB/DW Tk 7 PS	DW/WB	75.0				75.0								
WB/DW Tk 7 SB	DW/WB	69.3				69.3								
FW Tk 1 PS	FW	129.7						129.7						
FW Tk 1 SB	FW	129.7						129.7						
FW Tk 2 PS	FW	40.5						40.5						
FW Tk 2 SB	FW	40.5						40.5						
FW Tk 3 PS	FW	80.9						80.9						
FW Tk 3 SB	FW	80.9						80.9						
Potable Water Tk PS	Ships FW	83.7					83.7							
Potable Water Tk SB	Ships FW	84.1					84.1							
FO Overflow Tk	FO	35.9		35.9										
FO Day Tk PS	FO	15.2		15.2										
FO Day Tk SB	FO	15.2		15.2										
FO Settling Tk PS	FO	38.1		38.1										
FO Settling Tk SB	FO	38.1		38.1										
FO Tk 1 C	FO	100.3		100.3										
FO Tk 2 PS	FO	183.8		183.8										
FO Tk 2 SB	FO	183.8		183.8										
FO Tk 3 PS	FO	182.6		182.6										
FO Tk 3 SB	FO	182.6		182.6										
Liquid Mud Tk 1 PS	LM	362.0								362.0				
Liquid Mud Tk 1 SB	LM	362.0								362.0				
Liquid Mud Tk 2 PS	LM	286.8								286.8				
Liquid Mud Tk 2 SB	LM	286.8								286.8				
Liquid Mud Tk 4 PS	LM	341.3								341.3				
Liquid Mud Tk 4 SB	LM	341.3								341.3				
LM/Methanol Tk 3 PS	LM/METH	214.7								214.7	214.7			
LM/Methanol Tk 3 SB	LM/METH	214.7								214.7	214.7			
Lube Oil Tk	LO	1.9										1.9		
Dry Bulk Tk 1	Dry Bulk	83.2			83.2									
Dry Bulk Tk 2	Dry Bulk	83.2			83.2									
Dry Bulk Tk 3	Dry Bulk	83.2			83.2									
Dry Bulk Tk 4	Dry Bulk	83.2			83.2									
Dry Bulk Tk 5	Dry Bulk	83.2			83.2									
Total Volume [m ³]			0.0	975.8	415.8	1,832.2	167.9	2,006.2	0.0	2,409.7	429.4	1.9	0.0	0.0
Spec Sheet Total Volume [m ³]			0.0	909.4	415.8	328.3	167.9	2,006.2	0.0	2,409.7	429.4	1.9	0.0	0.0

*Capacities shown are for lead vessel. Actual capacities may vary slightly.

*Capacities shown in **RED** are excluded from the total volume.

*Capacities shown in **BLUE** are included in another Tank's Capacity.

*Capacities shown in **GREEN** are counted for multiple Tank Capacities.



KONGSBERG

DP Capability Plot

MAWEI 619-1

Case number : 1
 Case description :
 Thrusters active : T1-T4
 Rudders active :

Input file reference : foot_3398_A.scp
 Last modified : 2010-03-01 08.48 (v. 2.7.2)

Length overall : 87.0 m
 Length between perpendiculars : 83.0 m
 Breadth : 18.8 m
 Draught : 5.9 m
 Displacement : 6900.0 t (Cb = 0.73)
 Longitudinal radius of inertia : 20.8 m (= 0.25 * Lpp)
 Pos. of origin ahead of Lpp/2 (Xo) : 0.0 m
 Wind load coefficients : Calculated (Blendermann)
 Current load coefficients : Calculated (Strip-theory)
 Wave-drift load coefficients : Database (Scaled by Breadth/Length)

Tidal current direction offset : 0.0 deg
 Wave direction offset : 0.0 deg
 Wave spectrum type : JONSWAP (gamma = 3.30)
 Wind spectrum type : NPD
 Current - wave-drift interaction : OFF
 Load dynamics allowance : 1.0 * STD of thrust demand
 Additional surge force : 0.0 tf
 Additional sway force : 0.0 tf
 Additional yawing moment : 0.0 tf.m
 Additional force direction : Fixed
 Density of salt water : 1026.0 kg/m³
 Density of air : 1.226 kg/m³ (15 °C)

Power limitations : OFF
 Thrust loss calculation : ON

#	Thruster	X [m]	Y [m]	F+ [tf]	F- [tf]	Max [%]	Pe [kW]	Rudder
1	TUNNEL	34.7	0.0	13.6	-13.6	100	910	
2	AZIMUTH	31.8	0.0	14.1	-8.7	100	800	
3	AZIMUTH	-40.0	-4.0	35.4	-21.8	100	2000	
4	AZIMUTH	-40.0	4.0	35.4	-21.8	100	2000	

VARIABLE WIND AND WAVES
 Limiting 1 minute mean wind speed in knots
 at 10 m above sea level

ERN (99, 99, 86).
 ERN are subject to DNV approval

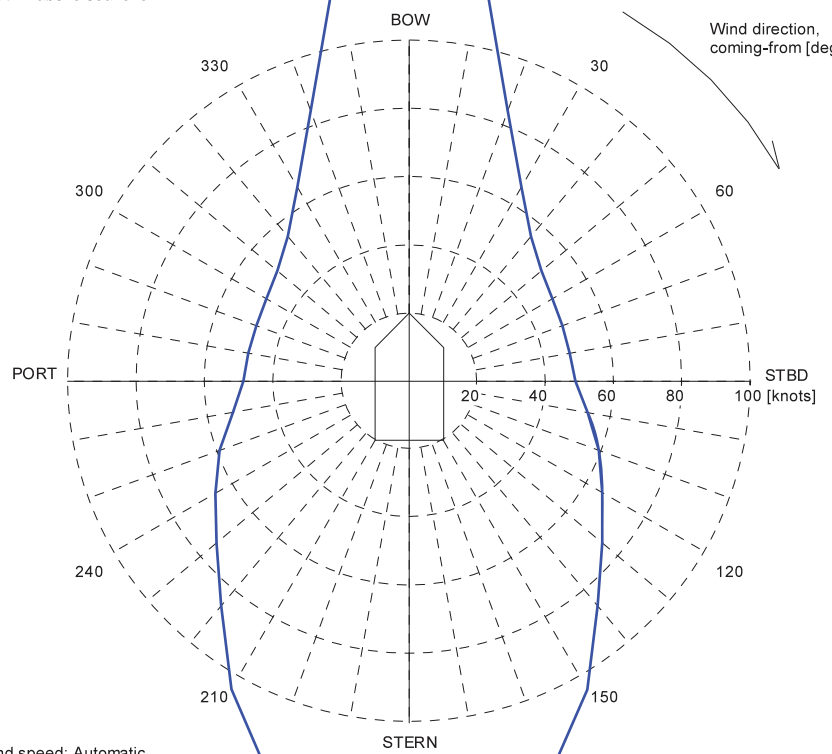

Wind speed: Automatic
 Significant wave height: DNV (ERN)
 Mean zero up-crossing period: DNV (ERN)

Rotating tidal current: 1.46 knots
 Rotating wind induced current: 0.000*Uwi knots